

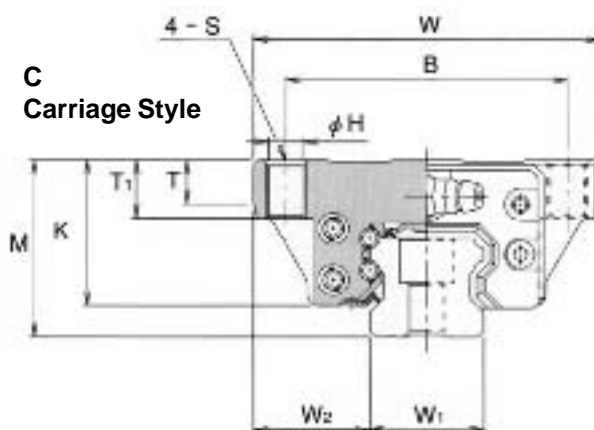

4-Way Equal Load Rating LM Guides

FEATURES

- Low noise
- Self-aligning capability
- Four way equal load rating
- Global standard dimensions
- Retained (interchangeable blocks and rails)
- Long-term, maintenance-free operation
- Rolling resistance variation is reduced to 1/10 of conventional full ball type
- Low center of gravity and high rigidity
- Excellent high-speed performance and long life

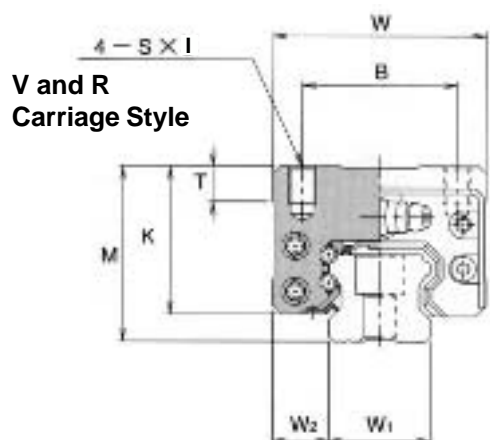

THK Model Number	Outline Dimensions			LM Block Dimensions											Grease Fitting
	Height M	Width W	Length L	B	C	S	I	H	L1	T	T1	K	N	E	
SHS 15 V	24	34	64.4	26	26	M4	4	-	48	6	-	21	5.5	5.5	PB1021B
SHS 15 R	28	34	64.4	26	26	M4	5	-	48	6	-	25	9.5	5.5	PB1021B
SHS 15 C	24	47	64.4	38	30	M5	-	4.4	48	6	8	21	5.5	5.5	PB1021B
SHS 20 V	30	44	79	32	36	M5	5	-	59	8	-	25.4	6.5	12	B-M6F
SHS 20 LV	30	44	98	32	50	M5	5	-	78	8	-	25.4	6.5	12	B-M6F
SHS 20 C	30	63	79	53	40	M6	-	5.4	59	7.2	10	25.4	6.5	12	B-M6F
SHS 20 LC	30	63	98	53	40	M6	-	5.4	78	7.2	10	25.4	6.5	12	B-M6F
SHS 25 V	36	48	92	35	35	M6	6.5	-	71	8	-	30.2	7.5	12	B-M6F
SHS 25 LV	36	48	109	35	50	M6	6.5	-	88	8	-	30.2	7.5	12	B-M6F
SHS 25 R	40	48	92	35	35	M6	8	-	71	8	-	34.2	11.5	12	B-M6F
SHS 25 LR	40	48	109	35	50	M6	8	-	88	8	-	34.2	11.5	12	B-M6F
SHS 25 C	36	70	92	57	45	M8	-	6.8	71	9	12	30.2	7.5	12	B-M6F
SHS 25 LC	36	70	109	57	45	M8	-	6.8	88	9	12	30.2	7.5	12	B-M6F

Catalog Number Logic

SHS20 R 2 SS + 220L

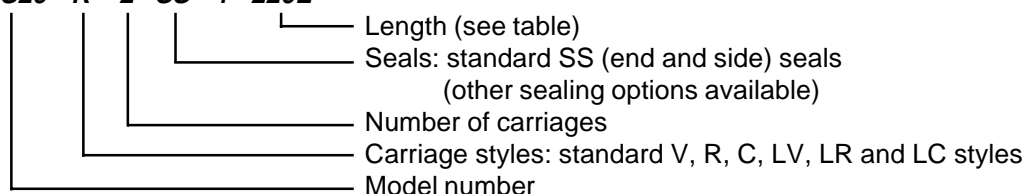

Please contact Techno for additional requirements

Type SHS with Caged Ball™ Technology



LM Guide type SHS is equipped with ball cage that uniformly arranges the balls. This enables the balls to move smoothly regardless of the mounting position, decreasing variation of rolling resistance and enabling a high degree of accuracy to be achieved. The ball recirculating sections of the SHS block are made of molded resin. This structure eliminates metallic noise caused by balls contacting the block and each other. Thus, SHS operates quietly even at high speed. In addition, the ball cage is effective in preventing balls from rubbing against each other, resulting in low heat generation and a super high-speed performance. The blocks are equipped with polyurethane seals on both ends and the bottom to help keep lubricants in and dirt and debris out.

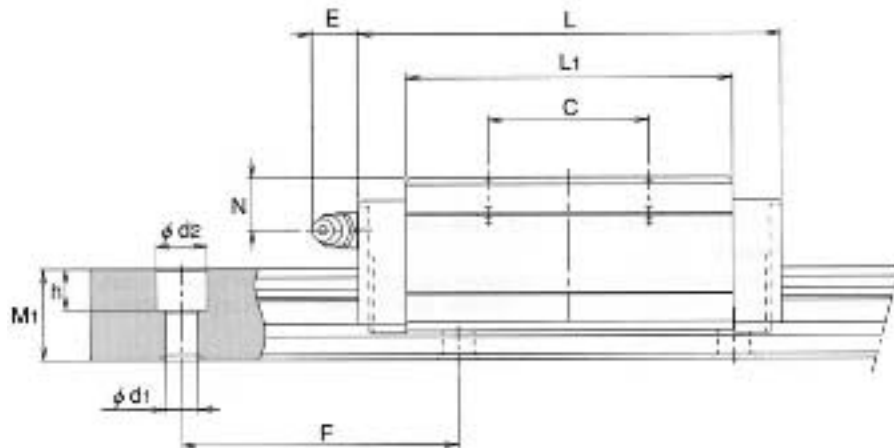

LM Rail Dimensions					Basic Load Rating		Weight	
Width	W2	Height	Pitch	d1xd2xh	C	C0	LM Block	LM Rail
W1		M1	F		kN	kN	kg	kg/m
15	9.5	13	60	4.5x 7.5x5.3	14.2	24.2	0.19	1.3
15	9.5	13	60	4.5x 7.5x5.3	14.2	24.2	0.22	1.3
15	16	13	60	4.5x 7.5x5.3	14.2	24.2	0.23	1.3
20	12	16.5	60	6x 9.5x8.5	22.3	38.4	0.35	2.3
20	12	16.5	60	6x 9.5x8.5	28.1	50.3	0.46	2.3
20	21.5	16.5	60	6x 9.5x8.5	22.3	38.4	0.46	2.3
20	21.5	16.5	60	6x 9.5x8.5	28.1	50.3	0.61	2.3
23	12.5	20	60	7x11x9	31.7	52.4	0.54	3.2
23	12.5	20	60	7x11x9	36.8	64.7	0.67	3.2
23	12.5	20	60	7x11x9	31.7	52.4	0.66	3.2
23	12.5	20	60	7x11x9	36.8	64.7	0.8	3.2
23	23.5	20	60	7x11x9	31.7	52.4	0.72	3.2
23	23.5	20	60	7x11x9	36.8	64.7	0.89	3.2

Available Options:

1. Non-Standard Radial Clearances
2. Stainless Steel Carriages and Rails
3. Different Lubrication Types
4. Higher Accuracy Grades

Note: Standard distance from the end of the rail to the first mounting hole is 20 mm.

Standard Lengths - mm

SHS15	SHS20	SHS25
220	220	460
460	460	820
820	1000	1600
1600*	1240	2500*
	2200*	

* Denotes maximum lengths available.